



Connecticut Department of  
 Energy & Environmental Protection  
 Bureau of Water Protection & Land Reuse  
 Land & Water Resources Division

## LWRD License Application Form I

### Coastal General Permit Registration for 4/40 Docks and Access Stairs

All sections of the LWRD License Application, when applicable, must be posted to the DEEP LWRD FTP site as instructed on Part VII of the LWRD Transmittal Form. See LWRD Application Instructions for general guidance.

Application Number as assigned in CPPU e-mail: 202005262  
 Applicant Name (same name used on Part III of the LWRD Transmittal Form): Kenneth Scott Jr.

#### Part I: Pre-Submission Consultations

The application process requires preliminary coordination and input from other agencies/groups depending on the activity and the location. Consultations with other agencies must occur prior to application submission. Please allow 6-8 weeks for the necessary coordination. For this application, the applicant should start with these consultations, as applicable (See Part VI for further guidance).

**Attachments:**

20	NDDB
21	Wildlife- osprey

#### Part II: Notifications

If your town has a Harbor Management Commission, submit a copy of this completed application by certified mail to the Commission and submit the certified mail receipt as Attachment 6 following this form.

#### Part III: Site and Resource Information

**1. SITE ADDRESS**  
 Address of Site: 38 Riverbend Drive City/Town: Mystic/Stonington State: CT Zip Code: 06355

**2. MUNICIPAL ZONING**  
 Is the proposed work consistent with municipal zoning requirements?  
 Yes  No If no, explain: \_\_\_\_\_

**3. WATERBODY/WATERCOURSES/WETLANDS**  
 List names of all waters impacted by the proposed activity: Mystic River

**4. INDIAN LANDS**  
 Is the activity that is the subject of this application located on federally recognized Indian lands?  Yes  No

**Part III: Site and Resource Information (continued)**

**5. AQUIFER PROTECTION AREAS**

Is the site located within a mapped Level A or Level B Aquifer Protection Area, as defined in CGS section 22a-354a through 22a-354bb?  Yes  No If yes, check one:  Level A or  Level B

If Level A, are any of the regulated activities, as defined in RCSA section 22a-354i-1(34), conducted on this site?  Yes  No If yes, and your business is **not** already registered with the Aquifer Protection Program, contact the aquifer protection agent or DEEP to take appropriate action.

For more information on the Aquifer Protection Area Program, contact the program at 860-424-3019 or visit the website at www.ct.gov/deep/aquiferprotection. See LWRD Application Instructions for further guidance.

**6. CONSERVATION OR PRESERVATION RESTRICTIONS**

Will the activity which is the subject of this application be located within a conservation or preservation restriction area?  Yes  No

If yes, provide proof of written notice of this application to the holder of such restriction, and/or a letter from the holder of such restriction verifying that this application is in compliance with the terms of the restriction, as Attachment 8.

**7. LICENSE HISTORY**

Indicate the number and date of issuance of any previous state permits or certificates issued by DEEP or USACE which authorized work at the site, and the names to whom they were issued.

<i>License/Permit/COP Authorization Number and Name of Agency</i>	<i>Date Issued</i>	<i>Name of Permittee/ Certificate Holder</i>	<i>Brief Description of Work Authorized</i>
<u>201402093-MG</u>	<u>3-31-2014</u>	<u>Ken &amp; Jayne Scott</u>	<u>Shorefront Modifications</u>
<u>NAE-2014-528</u>	<u>4-14-2014</u>	<u>Ken &amp; Jayne Scott</u>	<u>Shorefront Modifications</u>
_____	_____	_____	_____

**8. ENFORCEMENT HISTORY**

Is this application associated with a formal or informal enforcement action that is pending with DEEP?  Yes  No

If yes, please provide the enforcement action reference number and name of the DEEP staff contact:

Enforcement Action #: \_\_\_\_\_  
 DEEP Division/Program: \_\_\_\_\_  
 DEEP Staff Contact: \_\_\_\_\_

If the property was the subject of any historical enforcement actions known to the applicant, explain:

\_\_\_\_\_

**9. REGULATORY LIMIT - See Reference Guide for Regulatory Jurisdiction for further explanation if necessary.**

Indicate the landward extent of the State's regulatory jurisdiction by checking one box:

- Coastal Jurisdiction Line (CJL)** - for CJL information, refer to the Coastal Jurisdiction Fact Sheet and Chart.
- Mean High Water (MHW)** - for projects located upstream of a tide gate, dam or weir (structure must be shown on project plans).
- Tidal Wetland Boundary** - To be used if tidal wetlands are located landward of CJL or MHW. Include one foot above local extreme high water, if applicable.

**Part III: Site and Resource Information (continued)**

**10. TIDAL ELEVATIONS**

Provide site elevations for CJL, MHW, Mean Low Water (MLW) and the High Tide Line (HTL)\* in NAVD88. For general elevation reference, refer to USACE Tidal Flood Profiles.

CJL = 2.0    MHW = 0.9    MLW = -1.7    HTL = 0.0

\*The HTL is necessary for USACE jurisdiction and required as part of the USACE application.

**11. Coastal Resource Impact Table**

Check the applicable boxes below to identify coastal resources to be impacted by the proposed activity at the project site. Describe the impacts, as applicable. For definitions, refer to the

Resource Type	square feet			Describe Impacts
	Permanent impact	Temporary impact	Mitigation	
<input checked="" type="checkbox"/> Beaches/Dunes below HTL below CJL	8SF		None	Permanent Impact 8SF. There will be very little if any adverse impact to the existing beach below the CJL and HTL as a result of this project. Piles will be driven from a barge mounted crane with little sediment disturbances.
<input checked="" type="checkbox"/> Tidal Wetlands			None	No adverse impact; tidal wetlands vegetation limited to a strip along the bulkhead patch. Pile driving and stairs to the beach are clear of vegetative strip.
<input checked="" type="checkbox"/> Nearshore waters	4FT	130SF	None	The Mystic River is an estuarine embayment; no water flow impediment. Bottom contact 8SF

Resource Type	Describe Impacts (temporary and permanent)
<input type="checkbox"/> Benthic Habitat	This resource is not applicable to this project or site.
<input type="checkbox"/> Intertidal Flats	This resource is not applicable to this project or site.
<input type="checkbox"/> Submerged Aquatic Vegetation (SAV)	This resource is not applicable to this project or site.
<input checked="" type="checkbox"/> Rocky Shorefront	This site is at the toe of an eroding coastal bluff with accumulations of residual river stone from the erosion process scattered along the beach.
<input checked="" type="checkbox"/> Finfish	The upper Mystic River is flounder spawning grounds west of the channel. This project will not adversely affect that part of the river does not impede fish movements.
<input checked="" type="checkbox"/> Wildlife	The wildlife habitat on this site is the brush and understory on the bluff, attractive only to rodents and birds.
<input checked="" type="checkbox"/> Shellfish Areas	The upper Mystic River is suitable habitat for shellfish areas however not at this site due to the coarse gravel and rocky shorefront sediment characteristics.
<input checked="" type="checkbox"/> Coastal Hazard Area	Docks are not subject to FEMA restriction; they are not residential structures in a flood zone. This project will be built with tough materials and connections to resist damage.
<input checked="" type="checkbox"/> Bluffs/Escarpments	The proposed walkway and dock will be built at the toe of the bluff and will not adversely affect vegetation or bluff stability.
<input type="checkbox"/> Islands	This resource is not applicable to this project or site.
<input checked="" type="checkbox"/> Coastal Flooding	The dock facility will be built with suitable components and connections to withstand inundation due to coastal flooding.
<input type="checkbox"/> Water Circulation Patterns	The proposed dock facility is open pile and timber construction with no adverse impact on water flow and circulation patterns.
<input type="checkbox"/> Drainage Patterns	The proposed dock facility will have no impact on drainage patterns.
<input type="checkbox"/> Visual Quality	The proposed dock facility is consistent with shoreline dock facilities nearby.
<input type="checkbox"/> Water Quality	No erosion controls will be required for this project and no stormwater management or treatment requirements for this marine site or project.

## Part IV: Project Information

1. Describe the *existing* structures, conditions and uses at the site of the proposed work.  
**This site is an eroding wooded coastal bluff with a wood pile and timber bulkhead at the toe to provide stability. There are patches of tidal wetlands vegetation on the high beach below the bulkhead. There is an existing stairway down the bank to the beach and that will be retained. There is an undersized floating dock with a wood ramp and two anchor piles at the north end which will be removed. Public access along the rocky beach is limited.**
2. a. Describe the proposed regulated work and activities in a detailed narrative, including the number and dimensions of structures and the volume and area of fill or excavations.

**This project is to remove a 4.5FT x 12(+/-)FT float with associated floating access ramp and two piles, and a 30(+/-)SF storage container construct 4FT wide pile supported landing and stairs landward of the mean high water line and 3(+/-)LF waterward of the coastal jurisdiction line. Construct a 4FT wide x 10FT timber and pile ramp landing with rails and 2.5FT wide stairs to the beach, install an 8FT x 12.5FT float with float clearance skids an associated 30FT ramp landing float, hinged access ramp and restraint piles, also install a pile mounted small craft lift , waterward of the mean high water and coastal jurisdiction lines. eradicate 300 SF of phragmites between the bulkhead and MHW line south of the dock facility to allow for growth of tidal wetlands vegetation. Construct 69(+/-) LF of 4FT wide timber and pile pier with rails landward of the existing timber bulkhead and the Coastal Jurisdiction Line.**

- b. Describe the construction activities involved for the project in detail, including methods, sequencing, equipment, and any alternative construction methods that might be employed.

**Please see attached page 4a for detailed construction activities.**

- c. Describe any erosion and sedimentation or turbidity control installation and maintenance schedule and plans in detail. Such plans should be prepared in accordance with the 2002 Connecticut Guidelines for Soil Erosion and Sediment Control, as revised, established pursuant to CGS section 22a-328.

**There is no need for sedimentation or turbidity controls during this project.**

- d. Anticipated date of project initiation: **Spring or Summer of 2020**

Indicate the length of time needed to complete the project and identify any anticipated time restrictions:

**It is anticipated that the project will be completed in 2/3 months(+/-) weather permitting**

## Part V: General Permit Eligibility

Please confirm dock/access stair eligibility by checking the applicable boxes in the checklist below.

Not applicable	Confirm	Eligibility Requirements
	<input checked="" type="checkbox"/>	There is no submerged aquatic vegetation in the vicinity of the dock/stair.
	<input checked="" type="checkbox"/>	The site is a residential property.
	<input checked="" type="checkbox"/>	The dock/stair is not located in a right-of-way or easement.
	<input checked="" type="checkbox"/>	The dock/stair is not an obstruction to: navigation; pedestrian access at mean high water; or water access at adjacent parcels.
	<input checked="" type="checkbox"/>	The dock/stair is the only water access for this site. (It may be reasonable to propose a dock at a site with an existing stair depending on site circumstances – check with LWRD staff for guidance.)
<input type="checkbox"/>	<input checked="" type="checkbox"/>	The dock, including boat lift, hoist or davits, (tie-off pilings excluded) does not extend past a depth of -4.0' mean low water or a distance of 40' from mean high water, whichever is shortest.
<input type="checkbox"/>	<input checked="" type="checkbox"/>	Any fixed pier is $\leq$ 4.0' wide.
<input type="checkbox"/>	<input checked="" type="checkbox"/>	The most waterward float is $\leq$ 100 s.f. and any ramp landing float is $\leq$ 30 s.f.
<input type="checkbox"/>	<input checked="" type="checkbox"/>	Total dock surface area waterward of mean high water is $\leq$ 220 s.f.
<input type="checkbox"/>	<input checked="" type="checkbox"/>	For docks over tidal wetlands, there are no floats over the tidal wetland vegetation and the lowest horizontal member of any fixed pier is $\geq$ 5.0' off the substrate.
<input checked="" type="checkbox"/>	<input type="checkbox"/>	Site conditions allow for a float $\leq$ 100 s.f off a bulkhead or seawall with a ramp parallel to the wall and a 40 s.f. platform.

#### **Part IV: Project Information**

- b. Describe the construction activities involved for the project in detail, including methods, sequencing, equipment, and any alternative construction methods that might be employed.

**This project will have to be built from the water using a marine construction barge with deck mounted crane to drive float restraint and the ramp landing support piles using a pneumatic hammer and hoisting and installing framing and bracing for the pier. The floating dock and ramp will be built offsite and delivered by barge towed to the site the Mystic River and secured with driven piles. The landing float will be secured and then the ramp will be hoisted into position and secured to the fixed pier landing. The ramp landing and float installation work should be done at higher tides because of the skids. The remainder of the project could be done at any tide. The project duration should be about a month, depending on tides and weather.**

<input checked="" type="checkbox"/>	<input type="checkbox"/>	Access stairs are designed such that: no support piles, footing or landings are located over tidal wetlands; orientation is parallel to shore; stair is $\leq 4.0'$ wide; landing is $\leq 5.0'$ wide; and stair extends $\leq 6.0'$ off the toe of any wall.
-------------------------------------	--------------------------	---

## Part VI: Supporting Documents

The following attachments correspond to Form I. **If the Attachment name is followed by "REQUIRED", the attachment must be submitted with every application.** When submitting any supporting documents, please label the documents as indicated in this part (e.g., Attachment 21, etc.) and be sure to include the same applicant name used on Page 1 of this application form. Please check the box next to the attachments listed to indicate that they have been submitted, and provide the applicable attachments following this form. NOTE: Attachment numbering is NOT consecutive as the attachments relate to multiple LWRD program applications.

Attachment I.D.	Attachment Description
<input checked="" type="checkbox"/> Attachment 6	<b>Harbor Management Notification</b> If your town has a <u>Harbor Management Commission</u> , submit the certified mail receipt as proof that this completed application was sent by certified mail to the Commission.
<input type="checkbox"/> Attachment 8	<b>Conservation or Preservation Restriction Information</b> , if applicable.
<input checked="" type="checkbox"/> Attachment 10	<b>Photographs showing existing conditions of the site REQUIRED</b>
<input checked="" type="checkbox"/> Attachment 14	<b>Project Plans</b> , use <u>Project Plan Checklist</u> for requirements <b>REQUIRED</b>
<input checked="" type="checkbox"/> Attachment 20	<b>Natural Diversity Data Base (NDDB)</b> If the proposed activity is within an NDDB area, complete and submit a <u>Request for NDDB State Listed Species Review Form</u> (DEEP-APP-007) to the address specified on the form, <b>prior</b> to submitting this application. For NDDB maps and more information, visit the DEEP website at <a href="http://www.ct.gov/deep/nddbrequest">www.ct.gov/deep/nddbrequest</a> or call the NDDB staff at 860-424-3011.  Please note NDDB review generally takes 4 to 6 weeks and may require the applicant to produce additional documentation, such as ecological surveys, which must be completed prior to submitting this permit application. A copy of the NDDB Final Determination response letter that has not expired <b>must</b> be submitted as Attachment 20. Include a copy of any mitigation measures or management plan developed for this activity and approved by NDDB. Be aware that you must renew your NDDB Determination if it expires before project work commences.
<input type="checkbox"/> Attachment 21	<b>DEEP Wildlife Division – Osprey Consultation</b> If the proposed activity will occur within 300 feet of an osprey platform, please note that work will be prohibited between May 1 <sup>st</sup> and July 31 <sup>st</sup> unless a DEEP waiver is obtained. If this seasonal prohibition conflicts with the proposed work schedule, please contact the DEEP Wildlife Division's Wildlife Diversity Program staff at <a href="mailto:deep.wildlife@ct.gov">deep.wildlife@ct.gov</a> or 860-424-3011 for technical assistance before submitting your application. If you are seeking a seasonal prohibition waiver, documentation of the waiver issued by Wildlife Diversity Program staff must be submitted as Attachment 21. For known nesting locations, reference the Osprey Map at: <a href="https://www.google.com/maps/d/viewer?mid=1GyxnB-UAGxmseleCH9Zj4UdH1ug&amp;usp=sharing">https://www.google.com/maps/d/viewer?mid=1GyxnB-UAGxmseleCH9Zj4UdH1ug&amp;usp=sharing</a> or <a href="https://www.ctaudubon.org/citizen-science">https://www.ctaudubon.org/citizen-science</a> .
<input checked="" type="checkbox"/> Attachment 41	<b><u>Applicant Compliance Information Form</u></b> (DEEP-APP-002) <b>REQUIRED</b>
<input checked="" type="checkbox"/> Attachment 42	<b><u>Applicant Background Information Form</u></b> (DEEP-APP-008) <b>REQUIRED</b>
<input checked="" type="checkbox"/> Attachment 43	<b>Other Information:</b> Any other applicable information the applicant deems relevant or is required by DEEP.

## **EXECUTIVE SUMMARY**

### *Table of Contents*

<b><u>Attachment I.D.</u></b>	<b><u>Attachment Description</u></b>
<b>Attachment 6</b>	<b>Harbor Management Notification</b>
<b>Attachment 8</b>	<b>Conservation/Preservation Restriction Notification (not applicable)</b>
<b>Attachment 10</b>	<b>Photographs Showing Existing Conditions</b>
<b>Attachment 14</b>	<b>Project Plans</b>
<b>Attachment 20</b>	<b>Natural Diversity Data Base (NDDB)</b>
<b>Attachment 21</b>	<b>DEEP Wildlife Division-Osprey Consultation (not applicable)</b>
<b>Attachment 41</b>	<b>Applicant Compliance Information Form</b>
<b>Attachment 42</b>	<b>Applicant Background Information Form</b>
<b>Attachment 43</b>	<b>Other Information</b>

**Attachment 6**  
Harbor Management Notification



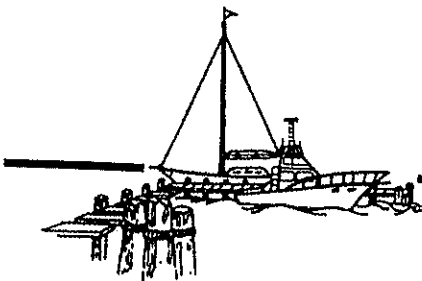

**Docko, Inc.** *Serving the waterfront community since 1987*

P.O. Box 421, Mystic, CT 06355 (860) 572-8939 Fax: (860) 572-7569, email: office@docko.com

April 22, 2020

Mr. David Carreau  
Mystic Harbor Management Commission  
101 Old North Road  
Mystic, CT 06460

Re: CT DEEP COP Application  
38 Riverbend Drive, Stonington

Dear Mr. Carreau:

It is required by the State of Connecticut Department of Energy & Environmental Protection, Land and Water Resource Division that we provide to the Harbor Management Commission of the Town, a copy of Certificate of Permission application and application drawings.

Please feel free to call our office if you have any questions.

Very truly yours,  
DOCKO, INC.

Christina Lopes  
Project Administrator

JM: cl  
Enclosures  
cc: CT DEEP/LWRD  
File: 19-05-3023 SCOTT

**Attachment 8**  
Conservation or Preservation Restriction Form  
(not applicable)

**Attachment 10**  
Photographs

**Attachment 14**  
**Project Plans**

NOTE: THE SHORELINE SHOWN ON THIS DRAWING IS BASED ON TOWN GIS PLANIMETRIC INFORMATION AND MAY NOT REFLECT THE CURRENT TIDE LINE LOCATIONS OR FEATURES.

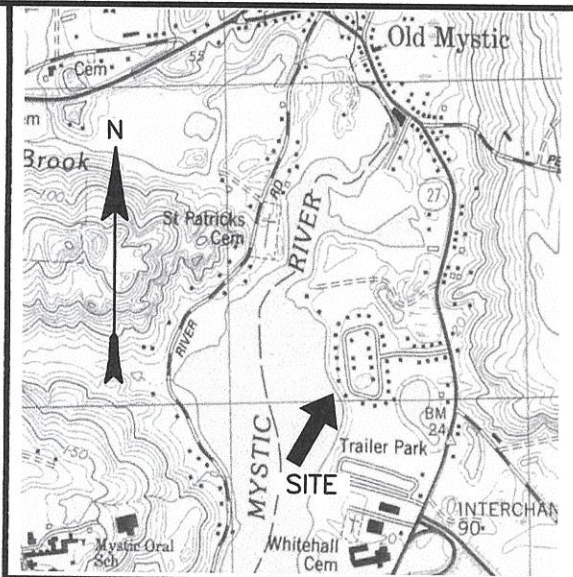
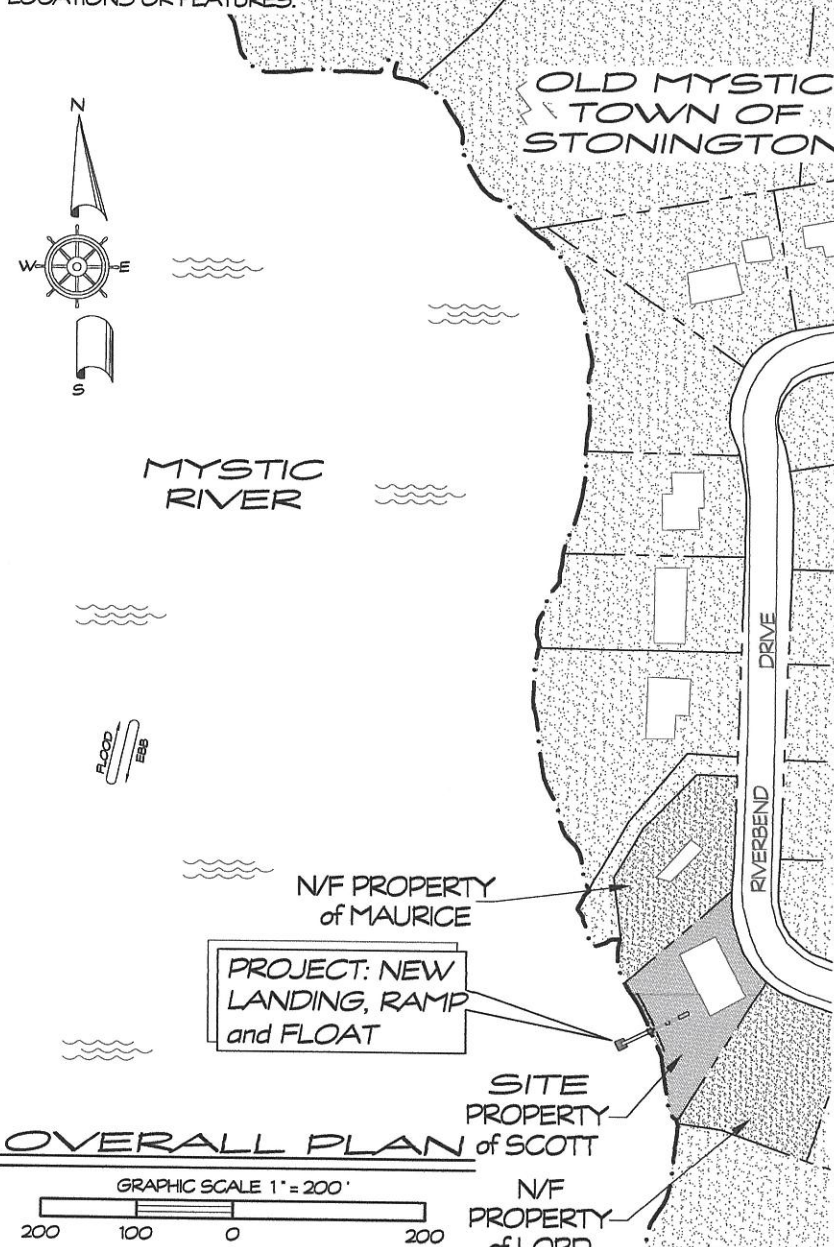

**LOCATION MAP**  
 REFERENCE  
 7.5 MINUTE  
 QUADRANGLE  
 OLD MYSTIC

- NOTES:
1. ELEVATION DATUM IS NAVD 1988 AND MEAN LOW WATER
  2. TIDE DATA IS TAKEN FROM 2019 NOAA TIDE TABLES REFERENCE : NEW LONDON. CJL IS TAKEN FROM THE COASTAL JURISDICTIONAL LINE FACT SHEET : STONINGTON
  3. PROJECT DESCRIPTION: THIS PROJECT IS TO REMOVE A 4.5-FT X 12½-FT FLOAT WITH ASSOCIATED FLOATING ACCESS RAMP AND TWO PILES, AND A 30±SF STORAGE CONTAINER CONSTRUCT 4-FT WIDE PILE SUPPORTED LANDING AND STAIRS LANDWARD OF THE MEAN HIGH WATER LINE AND 3±LF WATERWARD OF THE COASTAL JURISDICTION LINE. CONSTRUCT A 4-FT WIDE X 10±FT TIMBER AND PILE RAMP LANDING WITH RAILS AND 2.5FT WIDE STAIRS TO THE BEACH, INSTALL AN 8FT X 12.5FT FLOAT WITH FLOAT CLEARANCE SKIDS AN ASSOCIATED 30FT RAMP LANDING FLOAT, HINGED ACCESS RAMP AND RESTRAINT PILES, ALSO INSTALL A PILE MOUNTED SMALL CRAFT LIFT, WATERWARD OF THE MEAN HIGH WATER AND COASTAL JURISDICTION LINES. ERADICATE 300 SF OF PHRAGMITES BETWEEN THE BULKHEAD AND MHW LINE SOUTH OF THE DOCK FACILITY TO ALLOW FOR GROWTH OF TIDAL WETLANDS VEGETATION. CONSTRUCT 69(+/-) LF OF 4FT WIDE TIMBER AND PILE PIER WITH RAILS LANDWARD OF THE EXISTING TIMBER BULKHEAD AND THE COASTAL JURISDICTION LINE.
  4. PROJECT PURPOSE: THIS IS A REPLACEMENT PRIVATE DOCK FOR RECREATIONAL BOATING.

5. THESE APPLICATION DRAWINGS REPRESENT A COMPILATION OF SURVEYS FOR ENVIRONMENTAL PERMIT PURPOSES. THEY ARE NOT CONSTRUCTION CONTRACT DOCUMENTS. A TOWN BUILDING PERMIT MAY BE REQUIRED.

6. ADJOINING PROPERTY OWNERS:  
 NORTH: ANDRE J & JOYCE A MAURICE 36 RIVERBEND DRIVE MYSTIC, CT 06355  
 SOUTH: LEDA M (TRUSTEE), STEVEN M, RICHARD E LORD and DONNA L GORMAN 40 RIVERBEND DRIVE MYSTIC, CT 06355

PROJECT: **GENERAL PERMIT DOCK**  
 LOCATION: MYSTIC, TOWN OF STONINGTON  
 NEW LONDON COUNTY, CONNECTICUT  
 WATERWAY: MYSTIC RIVER  
 DATE: SEPTEMBER 13, 2019  
 APPLICANT: KEN AND JAYNE SCOTT  
 AGENT: SHEET 1 OF 4  
**DOCKO, INC.**  
 Keith B. Neilson, PE  
 Mystic, CT 06355  
 860 572 8939 FAX 860 572 7569  
 EMAIL: office@docko.com



DWG 11-13-2565

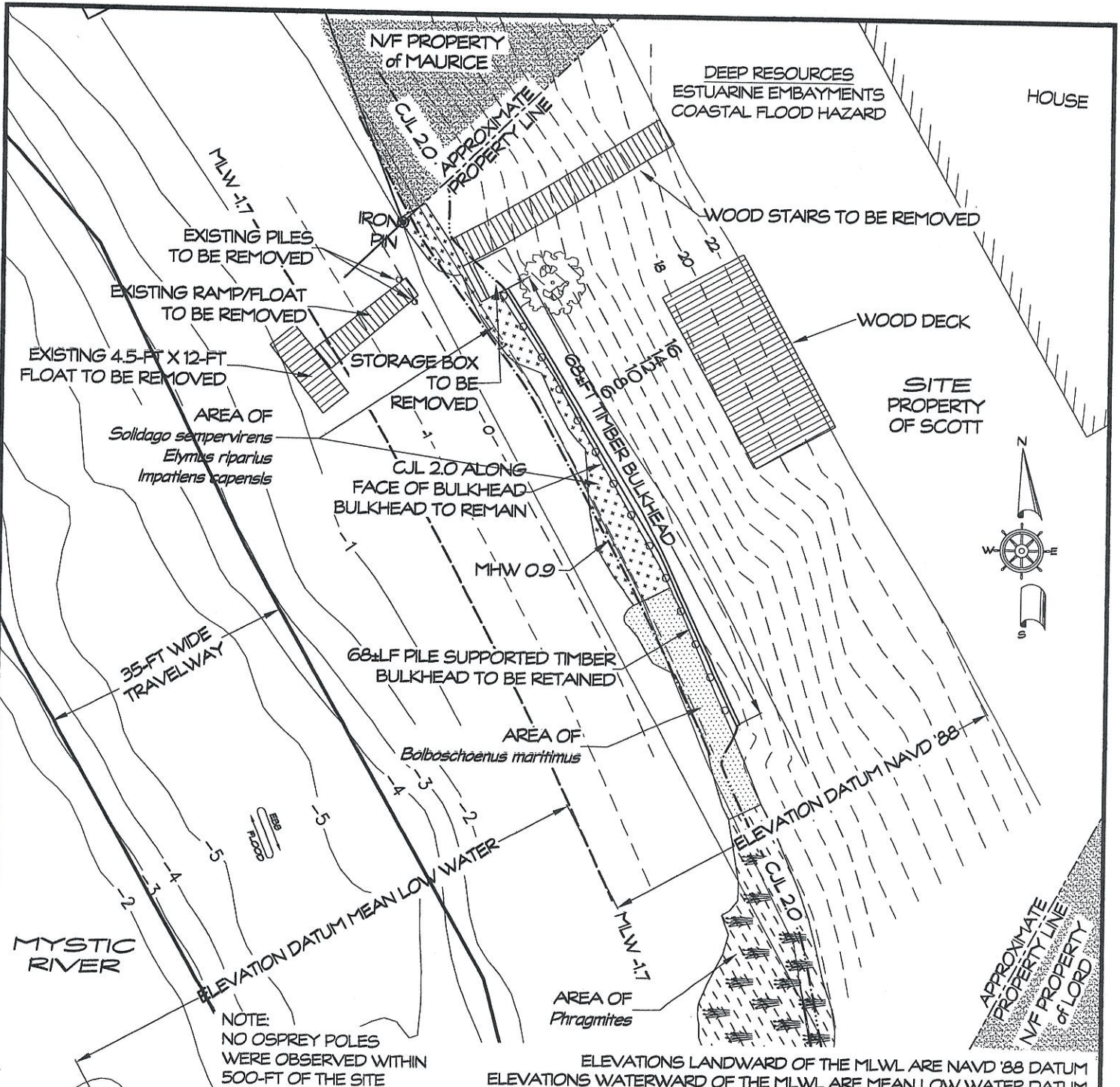

NOTE:  
NO OSPREY POLES  
WERE OBSERVED WITHIN  
500-FT OF THE SITE

ELEVATIONS LANDWARD OF THE MLWL ARE NAVD '88 DATUM  
ELEVATIONS WATERWARD OF THE MLWL ARE MEAN LOW WATER DATUM

**EXISTING CONDITIONS**

COMPILATION OF SURVEYS by JAMES BERNARDO LAND SURVEYING,  
RESOURCE MANAGEMENT & MAPPING AND HYDRO DATA INC.

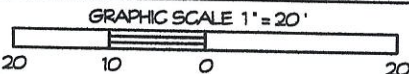

PROJECT: GENERAL PERMIT DOCK  
 LOCATION: MYSTIC, TOWN OF STONINGTON  
 NEW LONDON COUNTY, CONNECTICUT  
 WATERWAY: MYSTIC RIVER  
 DATE: SEPTEMBER 18, 2019  
 APPLICANT: KEN AND JAYNE SCOTT

AGENT: SHEET 2 OF 4  
**DOCKO, INC.**  
 Keith B. Neilson, PE  
 Mystic, CT 06355  
 860 572 8939 FAX 860 572 7569  
 EMAIL: office@docko.com

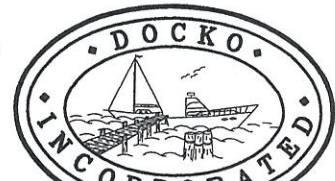

DWG 11-13-2565

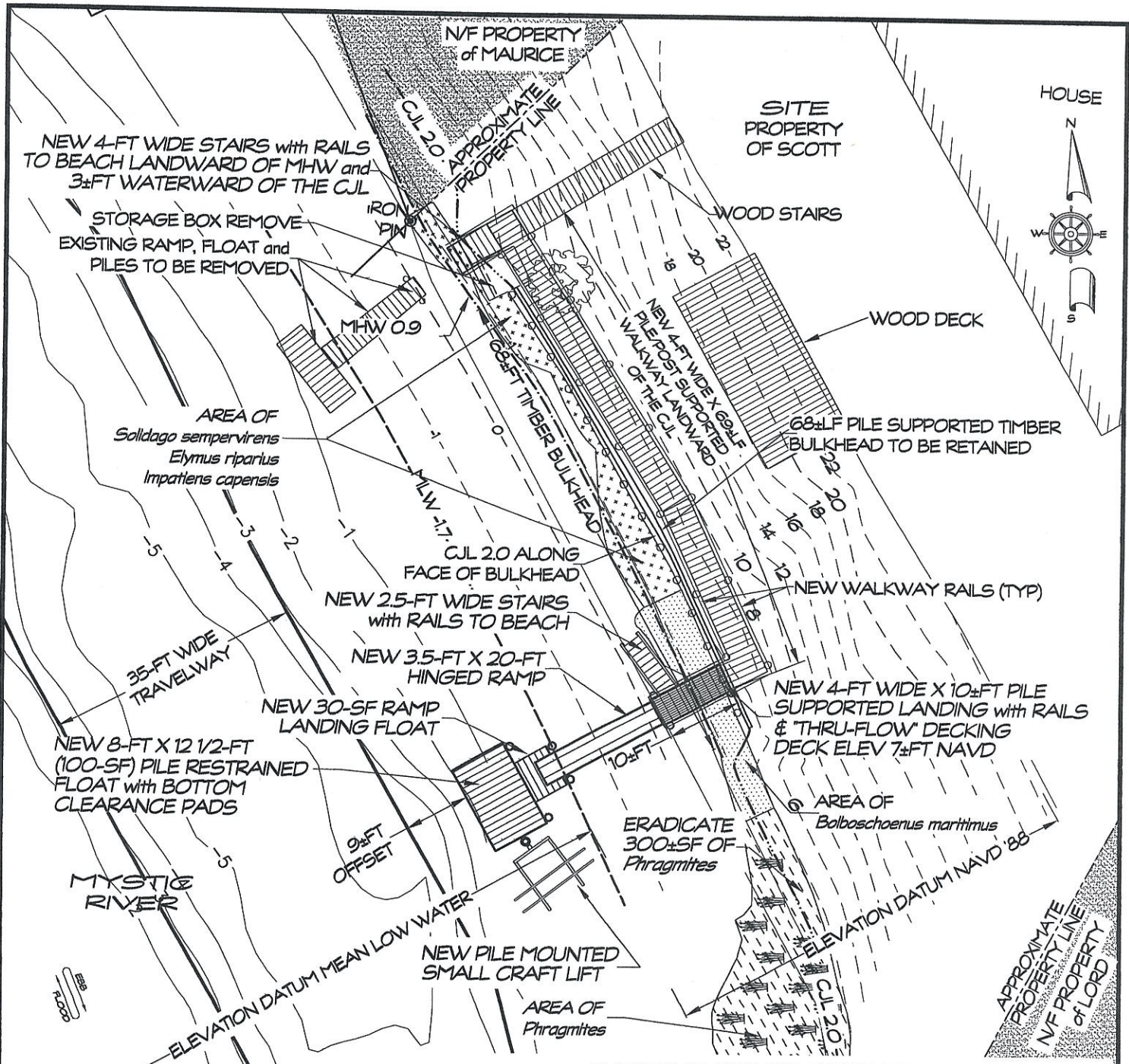

**PLAN VIEW**

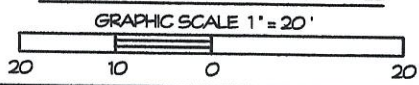

ELEVATIONS LANDWARD OF THE MLWL ARE NAVD '88 DATUM  
 ELEVATIONS WATERWARD OF THE MLWL ARE MEAN LOW WATER DATUM

COMPILATION OF SURVEYS by JAMES BERNARDO LAND SURVEYING,  
 RESOURCE MANAGEMENT & MAPPING AND HYDRO DATA INC.

PROJECT: GENERAL PERMIT DOCK  
 LOCATION: MYSTIC, TOWN OF STONINGTON  
 NEW LONDON COUNTY, CONNECTICUT  
 WATERWAY: MYSTIC RIVER  
 DATE: SEPTEMBER 18, 2019  
 APPLICANT: KEN AND JAYNE SCOTT

AGENT: SHEET 3 OF 4  
**DOCKO, INC.**  
 Keith B. Neilson, PE  
 Mystic, CT 06355  
 860 572 8939 FAX 860 572 7569  
 EMAIL: office@docko.com



DWG 11-13-2565



NOTE: THE ACCESS RAMP and NOT ALL RESTRAINT PILES ARE SHOWN IN THIS VIEW.

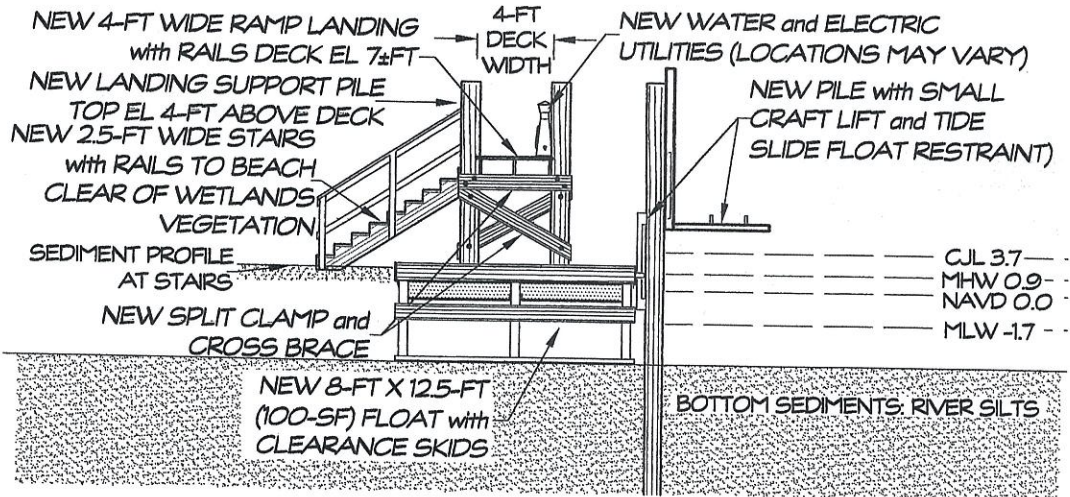

**END VIEW**

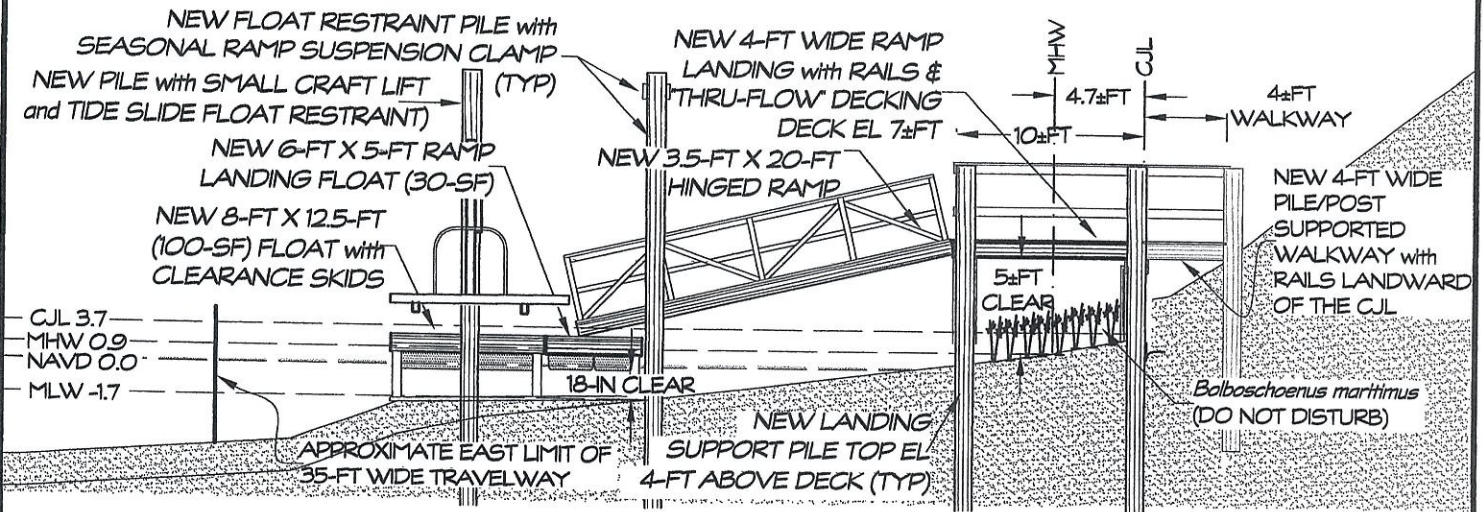
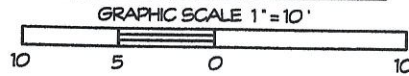

**PROFILE**

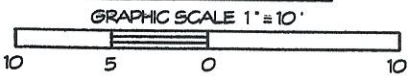

ELEVATIONS ARE REFERENCED TO NAVD '88



PROJECT: GENERAL PERMIT DOCK  
 LOCATION: MYSTIC, TOWN OF STONINGTON  
 NEW LONDON COUNTY, CONNECTICUT  
 WATERWAY: MYSTIC RIVER  
 DATE: SEPTEMBER 18, 2019  
 APPLICANT: KEN AND JAYNE SCOTT

AGENT: SHEET 4 OF 4  
**DOCKO, INC.**  
 Keith B. Nelson, PE  
 Mystic, CT 06355  
 860 572 8939 FAX 860 572 7569  
 EMAIL: office@docko.com



DWG 11-13-2565





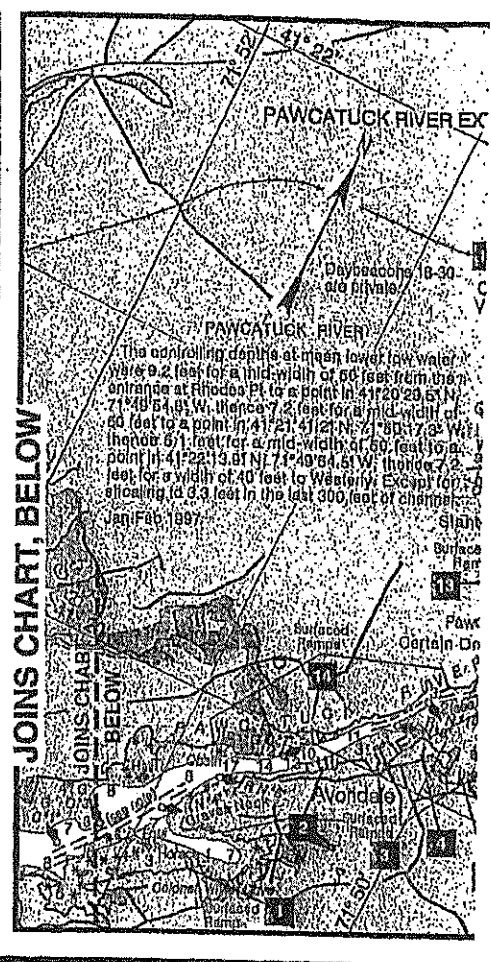
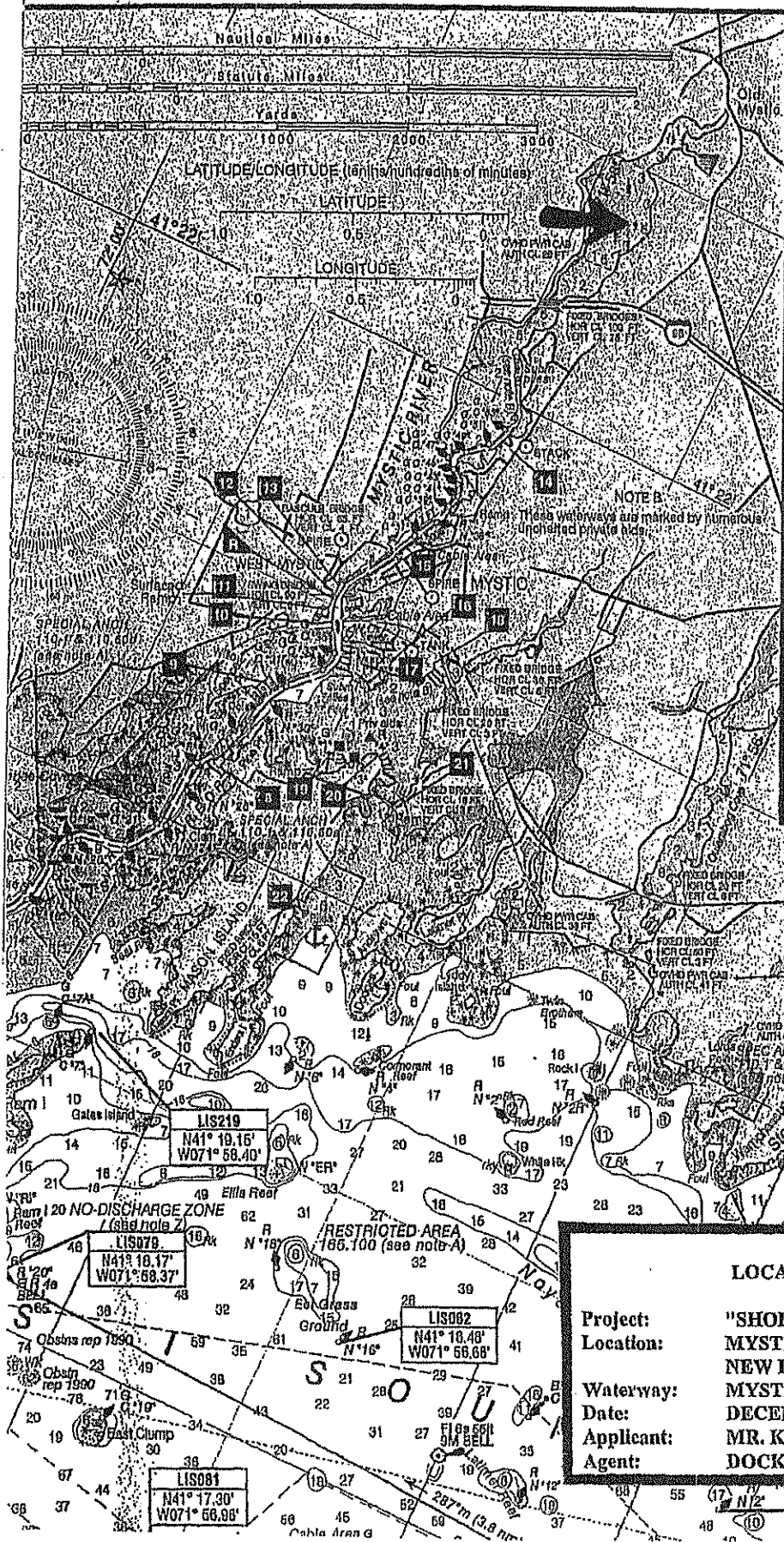

**LOCATION MAP**

**Project:** "SHOREFRONT MODIFICATIONS"  
**Location:** MYSTIC, TOWN OF STONINGTON  
 NEW LONDON COUNTY, CONNECTICUT  
**Waterway:** MYSTIC RIVER  
**Date:** DECEMBER 23, 2013  
**Applicant:** MR. KENNETH E. SCOTT, JR.  
**Agent:** DOCKO, INC.

JOINS CHART, BELOW

JOINS CHART, BELOW

LIS084  
N41° 18.54'  
W071° 54.59'

LIS219  
N41° 19.15'  
W071° 58.40'

LIS079  
N41° 18.17'  
W071° 58.37'

LIS082  
N41° 18.48'  
W071° 58.68'

LIS081  
N41° 17.30'  
W071° 58.98'

# Town of Stonington

Geographic Information System (GIS)



Date Printed: 5/29/2019



**MAP DISCLAIMER - NOTICE OF LIABILITY**

This map is for assessment purposes only. It is not for legal description or conveyances. All information is subject to verification by any user. The Town of Stonington and its mapping contractors assume no legal responsibility for the information contained herein.

Approximate Scale: 1 inch = 100 feet

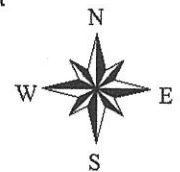
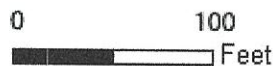

**Attachment 20**  
Natural Diversity Data Base (NDDB)

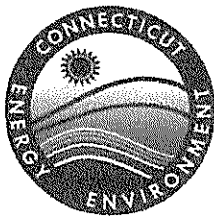

Connecticut Department of  
Energy & Environmental Protection  
Bureau of Natural Resources  
Wildlife Division

CPPU USE ONLY	
App #:	_____
Doc #:	_____
<b>Check #: No fee required</b>	
<b>Program: Natural Diversity Database Endangered Species</b>	
Hardcopy _____	Electronic _____

## Request for Natural Diversity Data Base (NDDDB) State Listed Species Review

Please complete this form in accordance with the [instructions](#) (DEEP-INST-007) to ensure proper handling of your request.

**There are no fees associated with NDDB Reviews.**

### Part I: Preliminary Screening & Request Type

Before submitting this request, you must review the most current Natural Diversity Data Base "State and Federal Listed Species and Significant Natural Communities Maps" found on the [DEEP website](#). These maps are updated twice a year, usually in June and December.

Does your site, including all affected areas, fall in an NDDDB Area according to the map instructions:

Yes     No

Enter the date of the map reviewed for pre-screening: December 2018

This form is being submitted for a :

- New NDDDB request
- Renewal/Extension of a NDDDB Request, without modifications and within two years of issued NDDDB determination (no attachments required)*

[CPPU Use Only - NDDDB-Listed Species Determination # 1736]

- New Safe Harbor Determination (optional) must be associated with an application for a GP for the Discharge of Stormwater and Dewatering Wastewaters from Construction Activities*
- Renewal/Extension of an existing Safe Harbor Determination*
  - With modifications
  - Without modifications (no attachments required)

[CPPU Use Only - NDDDB-Safe Harbor Determination # 1736]

Enter NDDDB Determination Number for Renewal/Extension:

Enter Safe Harbor Determination Number for Renewal/Extension:

## Part II: Requester Information

*\*If the requester is a corporation, limited liability company, limited partnership, limited liability partnership, or a statutory trust, it must be registered with the Secretary of State. If applicable, the name shall be stated **exactly** as it is registered with the Secretary of State. Please note, for those entities registered with the Secretary of State, the registered name will be the name used by DEEP. This information can be accessed at the Secretary of the State's database CONCORD. ([www.concord-sots.ct.gov/CONCORD/index.jsp](http://www.concord-sots.ct.gov/CONCORD/index.jsp))*

*If the requester is an individual, provide the legal name (include suffix) in the following format: First Name; Middle Initial; Last Name; Suffix (Jr, Sr., II, III, etc.).*

*If there are any changes or corrections to your company/facility or individual mailing or billing address or contact information, please complete and submit the [Request to Change company/Individual Information](#) to the address indicated on the form.*

### 1. Requester\*

Company Name: **Docko, Inc.**

Contact Name: **Keith B Neilson, P. E.**

Address: **P.O. Box 421**

City/Town: **Mystic**

State: **CT**

Zip Code: **06355**

Business Phone: **860-572-8939**

ext.

\*\*E-mail: **office@docko.com**

\*\*By providing this email address you are agreeing to receive official correspondence from the department, at this electronic address, concerning this request. Please remember to check your security settings to be sure you can receive emails from "ct.gov" addresses. Also, please notify the department if your e-mail address changes

a) Requester can best be described as:

Individual       Federal Agency       State agency       Municipality       Tribal

\*business entity (\* if a business entity complete i through iii):

i) Check type  corporation       limited liability company       limited partnership  
 limited liability partnership       statutory trust       Other:

ii) Provide Secretary of the State Business ID #: **0194033** This information can be accessed at the Secretary of the State's database (CONCORD). ([www.concord-sots.ct.gov/CONCORD/index.jsp](http://www.concord-sots.ct.gov/CONCORD/index.jsp))

iii)  Check here if your business is **NOT** registered with the Secretary of State's office.

b) Acting as (Affiliation), pick one:

Property owner       Consultant       Engineer       Facility owner       Applicant

Biologist       Pesticide Applicator       Other representative:

### 2. List Primary Contact to receive Natural Diversity Data Base correspondence and inquiries, if different from requester.

Company Name:

Contact Person:

Title:

Mailing Address:

City/Town:

State:

Zip Code:

Business Phone:

ext.

\*\*E-mail:

**Part III: Site Information**

This request can only be completed for one site. A separate request must be filed for each additional site.

**1. SITE NAME AND LOCATION**

Site Name or Project Name: **Scott New Dock Project**

Town(s): **Mystic, Town of Stonington**

Street Address or Location Description: **38 Riverbend Drive**

Size in acres, or site dimensions: **.37 Acres**

Latitude and longitude of the center of the site in decimal degrees (e.g., 41.23456 -71.68574):

Latitude: **41° 22' 50" N**

Longitude: **71° 57' 40" W**

Method of coordinate determination (check one):

GPS     Photo interpolation using CTECO map viewer     Other (specify): **Google Earth**

2a. Describe the current land use and land cover of the site.

**The site is zoned residential.**

b. Check all that apply and enter the size in acres or % of area in the space after each checked category.

<input type="checkbox"/> Industrial/Commercial _____	<input checked="" type="checkbox"/> Residential <u>100%</u>	<input type="checkbox"/> Forest _____
<input type="checkbox"/> Wetland _____	<input type="checkbox"/> Field/grassland _____	<input type="checkbox"/> Agricultural _____
<input type="checkbox"/> Water _____	<input type="checkbox"/> Utility Right-of-way _____	
<input type="checkbox"/> Transportation Right-of-way _____	<input type="checkbox"/> Other (specify): _____	

**Part IV: Project Information**

**1. PROJECT TYPE:**

Choose Project Type: Choose Type From Dropdown List , If other describe: New Dock Facility

2. Is the subject activity limited to the maintenance, repair, or improvement of an existing structure within the existing footprint?     Yes     No    If yes, explain.

**Part IV: Project Information (continued)**

3. Give a detailed description of the activity which is the subject of this request and describe the methods and equipment that will be used. Include a description of steps that will be taken to minimize impacts to any known listed species.

**The existing dock system will be removed. This includes the float and support/restraint piles. A new, wood piling timber pier with a hinged ramp and tie off piles will be installed in 3-4ft of water about 50ft southeast of the original dock.**

4. If this is a renewal or extension of an existing Safe Harbor request *with* modifications, explain what about the project has changed.

5. Provide a contact for questions about the project details if different from Part II primary contact.

Name:

Phone:

E-mail:



### Part V: Request Requirements and Associated Application Types

Check one box from either Group 1, Group 2 or Group 3, indicating the appropriate category for this request.

Group 1. If you check one of these boxes, complete Parts I – VII of this form and submit the required attachments A and B.

- Preliminary screening was negative but an NDDB review is still requested
- Request regards a municipally regulated or unregulated activity (no state permit/certificate needed)
- Request regards a preliminary site assessment or project feasibility study
- Request relates to land acquisition or protection
- Request is associated with a *renewal* of an existing permit or authorization, with no modifications

Group 2. If you check one of these boxes, complete Parts I – VII of this form and submit required attachments A, B, and C.

- Request is associated with a *new* state or federal permit or authorization application or registration
- Request is associated with modification of an existing permit or other authorization
- Request is associated with a permit enforcement action
- Request regards site management or planning, requiring detailed species recommendations
- Request regards a state funded project, state agency activity, or CEPA request

**Group 3.** If you are requesting a **Safe Harbor Determination**, complete Parts I-VII and submit required attachments A, B, and D. Safe Harbor determinations can only be requested if you are applying for a GP for the Discharge of Stormwater and Dewatering Wastewaters from Construction Activities

If you are filing this request as part of a state or federal permit application(s) enter the application information below.

Permitting Agency and Application Name(s):

DEEP/LWRD

Related State DEEP Permit Number(s), if applicable: pending

State DEEP Enforcement Action Number, if applicable: \_\_\_\_\_

State DEEP Permit Analyst(s)/Engineer(s), if known: Mr. Micheal Grzywinski

Is this request related to a previously submitted NDDB request?  Yes  No

If yes, provide the previous NDDB Determination Number(s), if known: \_\_\_\_\_

## Part VI: Supporting Documents

Check each attachment submitted as verification that *all* applicable attachments have been supplied with this request form. Label each attachment as indicated in this part (e.g., Attachment A, etc.) and be sure to include the requester's name, site name and the date. **Please note that Attachments A and B are required for all new requests and Safe Harbor renewals/extensions with modifications.** Renewals/Extensions with no modifications do not need to submit any attachments. Attachments C and D are supplied at the end of this form.

<input checked="" type="checkbox"/> Attachment A:	<b>Overview Map:</b> an 8 1/2" X 11" print/copy of the relevant portion of a USGS Topographic Quadrangle Map clearly indicating the exact location of the site.
Attachment B:	<b>Detailed Site Map:</b> fine scaled map showing site boundary and area of work details on aerial imagery with relevant landmarks labeled. (Site and work boundaries in GIS [ESRI ArcView shapefile, in NAD83, State Plane, feet] format can be substituted for detailed maps, see instruction document)
<input checked="" type="checkbox"/> Attachment C:	<b>Supplemental Information, Group 2 requirement (attached, DEEP-APP-007C)</b> <input checked="" type="checkbox"/> Section i: Supplemental Site Information and supporting documents <input checked="" type="checkbox"/> Section ii: Supplemental Project Information and supporting documents
<input type="checkbox"/> Attachment D:	<b>Safe Harbor Report Requirements, Group 3 (attached, DEEP-APP-007D)</b>

## Part VII: Requester Certification

The requester *and* the individual(s) responsible for actually preparing the request must sign this part. A request will be considered incomplete unless all required signatures are provided.

<p>"I have personally examined and am familiar with the information submitted in this document and all attachments thereto, and I certify that based on reasonable investigation, including my inquiry of the individuals responsible for obtaining the information, the submitted information is true, accurate and complete to the best of my knowledge and belief."</p>	
 Signature of Requester (a typed name will substitute for a handwritten signature)	<b>5/29/2019</b> Date
<b>Owen Roberge</b> Name of Requester (print or type)	<b>Environmental Specialist</b> Title (if applicable)
Signature of Preparer (if different than above)	Date
Name of Preparer (print or type)	Title (if applicable)

Note: Please submit the completed Request Form and all Supporting Documents to:

CENTRAL PERMIT PROCESSING UNIT  
 DEPARTMENT OF ENERGY & ENVIRONMENTAL PROTECTION  
 79 ELM STREET  
 HARTFORD, CT 06106-5127

Or email request to: [deep.nddbrequest@ct.gov](mailto:deep.nddbrequest@ct.gov)

# Attachment C: Supplemental Information, Group 2 requirement

## Section i: Supplemental Site Information

### 1. Existing Conditions

Describe all natural and man-made features including wetlands, watercourses, fish and wildlife habitat, floodplains and any existing structures potentially affected by the subject activity. Such features should be depicted and labeled on the site plan that must be submitted. Photographs of current site conditions may be helpful to reviewers.

**The site is located in an Estuarine Embayment in the upper part of the Mystic River subject to coastal flooding. There are patches of tidal wetland vegetation in the area. It is a partially developed waterfront with a modified bluff bulkhead.**

- Site Photographs (optional) attached
- Site Plan/sketch of existing conditions attached

### 2. Biological Surveys

Has a biologist visited the site and conducted a biological survey to determine the presence of any endangered, threatened or special concern species  Yes  No

If yes, complete the following questions and submit any reports of biological surveys, documentation of the biologist's qualifications, and any NDDDB survey forms.

Biologist(s) name: \_\_\_\_\_

Habitat and/or species targeted by survey: \_\_\_\_\_

Dates when surveys were conducted: \_\_\_\_\_

- Reports of biological surveys attached
- Documentation of biologist's qualifications attached
- [NDDDB Survey forms](#) for any listed species observations attached

## Section ii: Supplemental Project Information

1. Provide a schedule for all phases of the project including the year, the month and/or season that the proposed activity will be initiated and the duration of the activity.

**It is estimated that construction will begin once all permits are received, most likely in the fall of 2019.**

2. Describe and quantify the proposed changes to existing conditions and describe any on-site or off-site impacts. In addition, provide an annotated site plan detailing the areas of impact and proposed changes to existing conditions.

There are no known adverse environmental impacts associated with this project.

- Annotated Site Plan attached

## Attachment D: Safe Harbor Report Requirements

Submit a report, as Attachment D, that synthesizes and analyzes the information listed below. Those providing synthesis and analysis need appropriate qualifications and experience. A request for a safe harbor determination shall include:

1. **Habitat Description and Map(s), including GIS mapping overlays, of a scale appropriate for the site, identifying:**
  - wetlands, including wetland cover types;
  - plant community types;
  - topography;
  - soils;
  - bedrock geology;
  - floodplains, if any;
  - land use history; and
  - water quality classifications/criteria.
2. **Photographs** - The report should include photographs of the site taken from the ground and also all reasonably available aerial or satellite photographs and an analysis of such photographs.
3. **Inspection** - A visual inspection(s) of the site should be conducted, preferably when the ground is visible, and described in the report. This inspection can be helpful in confirming or further evaluating the items noted above.
4. **Biological Surveys** - The report should include all biological surveys of the site where construction activity will take place that are reasonably available to a registrant. A registrant shall notify the Department's Wildlife Division of biological studies of the site where construction activity will take place that a registrant is aware of but are not reasonably available to the registrant.
5. **Based on items #1 through 4 above, the report shall include a Natural Resources Inventory of the site of the construction activity.** This inventory should also include a review of reasonably available scientific literature and any recommendations for minimizing adverse impacts from the proposed construction activity on listed species or their associated habitat.
6. **In addition, to the extent the following is available at the time a safe harbor determination is requested, a request for a safe harbor determination shall include and assess:**
  - Information on Site Disturbance Estimates/Site Alteration information
  - Vehicular Use
  - Construction Activity Phasing Schedules, if any; and
  - Alteration of Drainage Patterns

# Town of Stonington

Geographic Information System (GIS)



Date Printed: 5/29/2019



**MAP DISCLAIMER - NOTICE OF LIABILITY**

This map is for assessment purposes only. It is not for legal description or conveyances. All information is subject to verification by any user. The Town of Stonington and its mapping contractors assume no legal responsibility for the information contained herein.

Approximate Scale: 1 inch = 100 feet





41°22'49.8"N 71°57'39.5"W

41.380489, -71.960980

-   
Directions
-   
Save
-   
Nearby
-   
Send to your  
phone
-   
Share



New London County, CT 06355



92JQ+5J Stonington, Connecticut

**Attachment 21**  
DEEP Wildlife Division-Osprey Consultation  
(not applicable)

**Attachment 41**  
Applicant Compliance Information Form





Connecticut Department of Energy & Environmental Protection

Applicant Compliance Information

DEEP ONLY
App. No.
Co./Ind. No.

Applicant Name: Kenneth E. Scott Jr.

Mailing Address: 38 Riverbend Drive

City/Town: Stonington

State: CT

Zip Code: 06355

Business Phone: 860-433-1241

ext.:

Fax:

Contact Person: Ken Scott

Phone: 860-433-1241 ext.

\*E-mail: k.scott@snet.net

If you answer yes to any of the questions below, you must complete the Table of Enforcement Actions on the reverse side of this sheet as directed in the instructions for your permit application.

A. During the five years immediately preceding submission of this application, has the applicant been convicted in any jurisdiction of a criminal violation of any environmental law?

[ ] Yes [X] No

B. During the five years immediately preceding submission of this application, has a civil penalty been imposed upon the applicant in any state, including Connecticut, or federal judicial proceeding for any violation of an environmental law?

[ ] Yes [X] No

C. During the five years immediately preceding submission of this application, has a civil penalty exceeding five thousand dollars been imposed on the applicant in any state, including Connecticut, or federal administrative proceeding for any violation of an environmental law?

[ ] Yes [X] No

D. During the five years immediately preceding submission of this application, has any state, including Connecticut, or federal court issued any order or entered any judgement to the applicant concerning a violation of any environmental law?

[ ] Yes [X] No

E. During the five years immediately preceding submission of this application, has any state, including Connecticut, or federal administrative agency issued any order to the applicant concerning a violation of any environmental law?

[ ] Yes [X] No

## Table of Enforcement Actions

(1) Type of Action	(2a) Date Commenced	(2b) Date Terminated	(3) Jurisdiction	(4) Case/Docket/ Order No.	(5) Description of Violation

Check the box if additional sheets are attached. Copies of this form may be duplicated for additional space.

**Attachment 42**  
Applicant Background Information

## Applicant Background Information (continued)

**Voluntary Association**

Check box if additional sheets are necessary. If so, label and attach additional sheet(s) to this sheet with the required information.

1. List authorized persons of association or list all members of association.

Name:  
Mailing Address:  
City/Town: State: Zip Code:  
Business Phone: ext.:  
E-mail:

Name:  
Mailing Address:  
City/Town: State: Zip Code:  
Business Phone: ext.:  
E-mail:

Name:  
Mailing Address:  
City/Town: State: Zip Code:  
Business Phone: ext.:  
E-mail:

Name:  
Mailing Address:  
City/Town: State: Zip Code:  
Business Phone: ext.:  
E-mail:

**Individual or Other Business Type**

Check the box, if additional sheets are necessary. If so, label and attach additional sheet(s) to this sheet with the required information.

1. Name: **Kenneth E. Scott Jr.**  
Mailing Address: 38 Riverbend Drive  
City/Town: Stonington State: CT Zip Code: 06355  
Business Phone: 860-912-6677 ext.:  
E-mail: k.scott@snet.net

2. State other names by which the applicant is known, including business names.  
Name:

**Attachment 43**  
Other Information